

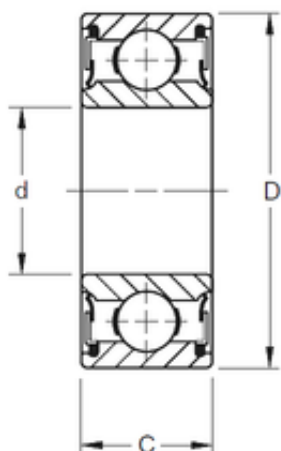

ISOSTATIC BEARING LIMITED



40 mm x 80 mm x 30,18 mm TIMKEN W208PP Single Row Ball Bearings

Bearing No. W208PP

Size	40x80x30.18 mm
Bore Diameter	40 mm
Outer Diameter	80 mm
Width	30,18 mm
d	40 mm
D	80 mm
B	30,18 mm
C	30,18 mm
Weight	0,63 Kg
Basic dynamic load rating (C)	36000 kN

W208PP Bearing 2D drawings and 3D CAD models