

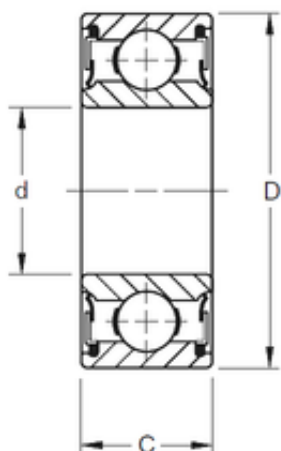

ISOSTATIC BEARING LIMITED



35 mm x 72 mm x 26,97 mm TIMKEN W207PP Single Row Ball Bearings

Bearing No. W207PP

Size	35x72x26.97 mm
Bore Diameter	35 mm
Outer Diameter	72 mm
Width	26,97 mm
d	35 mm
D	72 mm
B	26,97 mm
C	26,97 mm
Weight	0,458 Kg
Basic dynamic load rating (C)	28500 kN

W207PP Bearing 2D drawings and 3D CAD models