

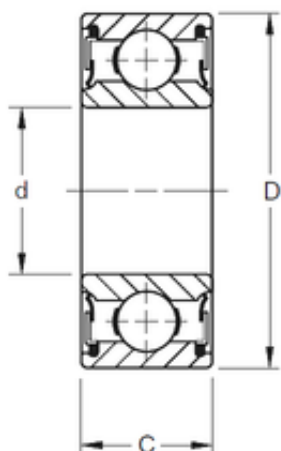

ISOSTATIC BEARING LIMITED



20 mm x 42 mm x 12 mm TIMKEN 9104PP Single Row Ball Bearings

Bearing No. 9104PP

Size	20x42x12 mm
Bore Diameter	20 mm
Outer Diameter	42 mm
Width	12 mm
d	20 mm
D	42 mm
B	12 mm
C	12 mm
Weight	0,073 Kg
Basic dynamic load rating (C)	10,7 kN

9104PP Bearing 2D drawings and 3D CAD models