

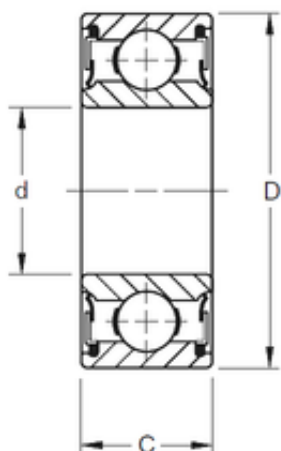

## ISOSTATIC BEARING LIMITED



### 10 mm x 26 mm x 8 mm TIMKEN 9100PP Single Row Ball Bearings

Bearing No. 9100PP

Size	10x26x8 mm
Bore Diameter	10 mm
Outer Diameter	26 mm
Width	8 mm
d	10 mm
D	26 mm
B	8 mm
C	8 mm
Weight	0,018 Kg
Basic dynamic load rating (C)	5,16 kN

9100PP Bearing 2D drawings and 3D CAD models