

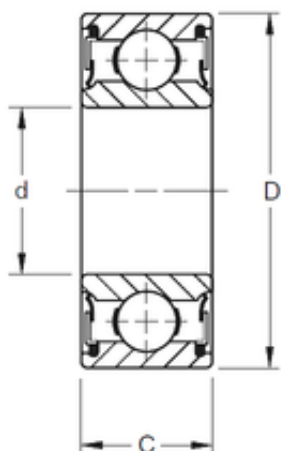

ISOSTATIC BEARING LIMITED



50 mm x 110 mm x 27 mm TIMKEN 310PP Single Row Ball Bearings

Bearing No. 310PP

Size	50x110x27 mm
Bore Diameter	50 mm
Outer Diameter	110 mm
Width	27 mm
d	50 mm
D	110 mm
B	27 mm
C	27 mm
Weight	1,125 Kg
Basic dynamic load rating (C)	69,3 kN

310PP Bearing 2D drawings and 3D CAD models