

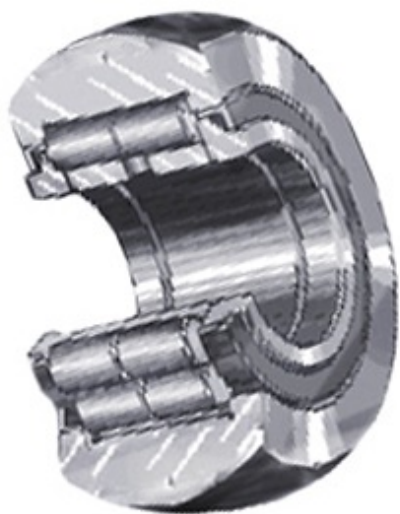

ISOSTATIC BEARING LIMITED

INA PWTR20-2RS Cam Follower and Track Roller - Yoke Type



Bearing No. PWTR20-2RS

PWTR20-2RS Bearing 2D drawings and 3D CAD models

| | |
|------------------------|---|
| Category | Cam Follower and Track Roller - Yoke Type |
| Inventory | 0.0 |
| Manufacturer Name | SCHAEFFLER GROUP |
| Minimum Buy Quantity | N/A |
| Weight | 0.293 |
| EAN | 4012802844719 |
| Product Group | B04120 |
| Roller Surface Profile | Crowned |
| Profile | Yoke Type |
| Enclosure | Sealed |
| Rolling Element | Cylindrical Roller Bearing-Double Row |
| Relubricatable | Yes |
| Inch - Metric | Metric |
| Other Features | Full Complement With Inner Ring Contact Lip Seals |
| Long Description | 20MM Bore; 47MM Roller Diameter; 24MM Roller Width; Crowned Roller Surface Profile; Sealed Enclosure; Cylindrical Roller Bearing-Double Row; Relubricatable |
| Category | Cam Followers Yoke Type |
| UNSPSC | 31171530 |
| Harmonized Tariff Code | 8482.50.00.00 |
| | |



ISOSTATIC BEARING LIMITED

| Noun | Bearing |
|--------------------------|---|
| Keyword String | Cam Follower |
| Manufacturer URL | http://www.ina.com |
| Manufacturer Item Number | PWTR20.2RS |
| Weight / LBS | 0.54 |
| d | 0.787 Inch 20 Millimeter |
| Roller Width | 0.945 Inch 24 Millimeter |
| Roller Diameter | 1.85 Inch 47 Millimeter |